

Town of Abita Springs

Date: 11/18/24

Type of Approval

- Owner
 Applicant

- Sign Fence
 Other: _____

APPLICATION FOR PERMIT TO: *(Briefly describe project- Use separate paper if necessary)*

ADD FENCE TO BACK YARD AND LATTICE UNDER
HOUSE BETWEEN PETS

APPLICANT NAME: SAMANTHA LEONE

Email: SLEONE21@GMAIL.COM Phone: 630-254-3745

Address: 22176 12TH ST ABITA SPRINGS LA 70420

OWNER (IF DIFFERENT FROM APPLICANT): _____

Email: _____ Phone: _____

Address: _____

CONTRACTOR NAME & COMPANY: FENCE KING

Email: SUPPORT@FENCE THIS YARD.COM Phone: 985-966-0604

Address: 19399 HELENBURG RD STE 208 COVINGTON, LA 70433

 11/18/24
Signature of Owner Date Signature of Applicant Date

----- **Do Not Write Below this Line** -----

7 DAYS NOTICE REQUIRED BEFORE FINAL APPROVAL OF CONSTRUCTION. IF YOU BUILD IN THE HISTORIC DISTRICT APPROVAL MUST BE GIVEN BEFORE YOUR CERTIFICATE OF OCCUPANCY WILL BE ISSUED.

Commissioners Initial

Ron Blicht _____

Otto Dinkelacker _____

Thad Mancil _____

Andre Monnot _____

Paul Vogt _____

Review Date: _____

Approved: _____

Commissioner Assigned: _____

Work Completed as Presented: _____

Inspected on Date: _____

Town of Abita Springs

SUBJECT PROPERTY

Street Address or Legal Description: 22176 12TH ST
Nearest Cross Streets: 12TH ST + ST JOHN Lot Dimensions: 100' x 150'
Work Begins: 12/11/24 Estimated Completion Date: 12/31/24

DETAILS ABOUT YOUR SIGN OR FENCE

SIGNS

Location: Permanent Temporary Location: On Building Hanging
Size of Sign: Two-Sided Sign? Yes No
Sign Material: Post Material:
Height of Sign:
Describe Sign Lighting:
Notes:

FENCE

Location: BACK YARD FOLLOWING DRIVEWAY + PROPERTY LINE
Style: PICKET Height: 4'
Material: TREATED PINE
Type: 4' Picket 7' Privacy 6' Privacy with 2' Lattice
Set Back Requirements:
Notes: THE 15' PIECE BEHIND THE GARAGE WILL BE A 6'
DOG EAR PRIVACY FENCE TO MATCH THE NEIGHBORS
PAINT DETAILS FENCE BEHIND

Details: _____

OTHER

Give Details: VINYL LATTICE WILL BE INSTALLED
BETWEEN PETS UNDER HOUSE

Google Map with Location

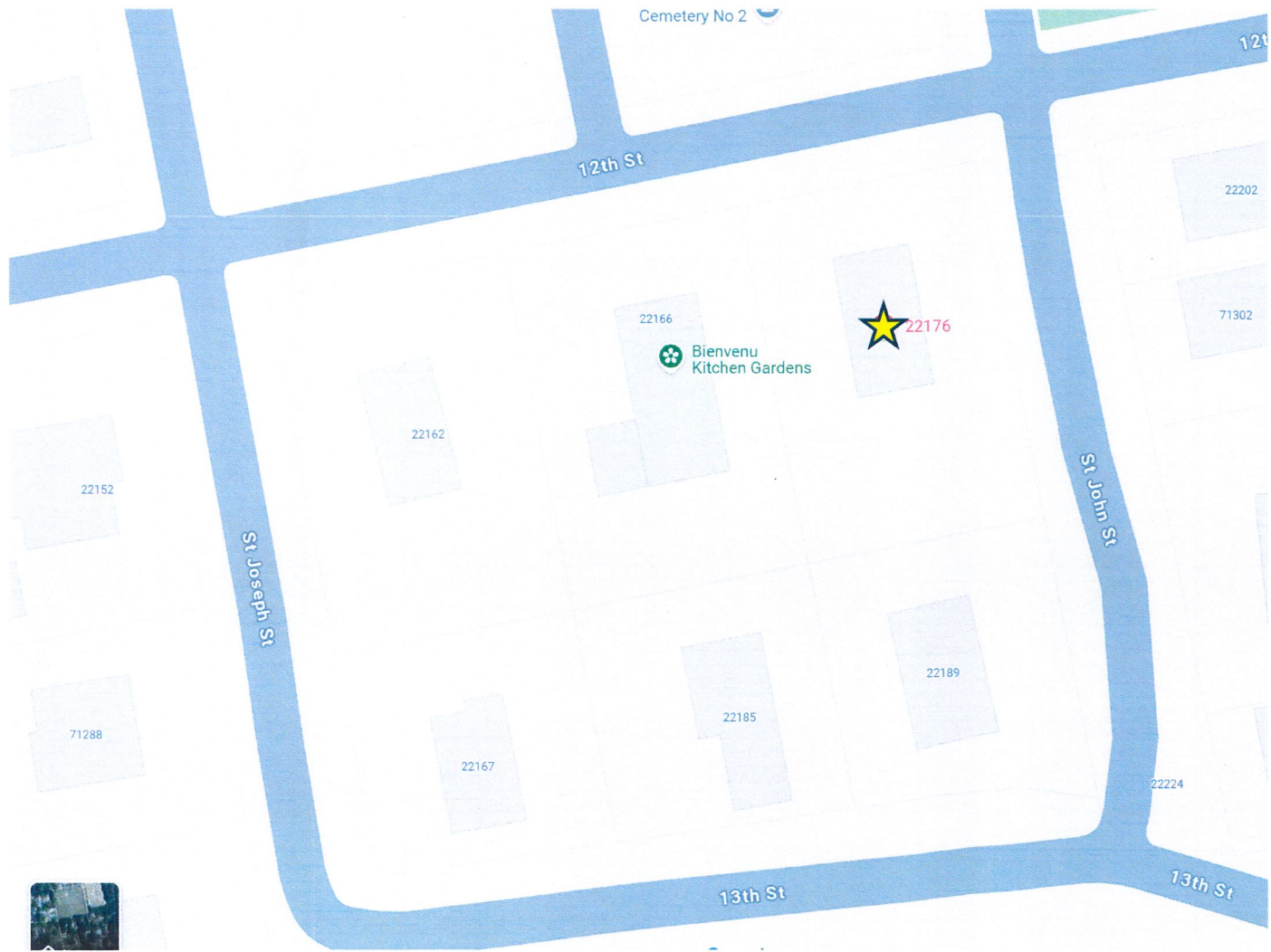

Street View (Front)



Street View (Side)



Site Plan



Sample Photos

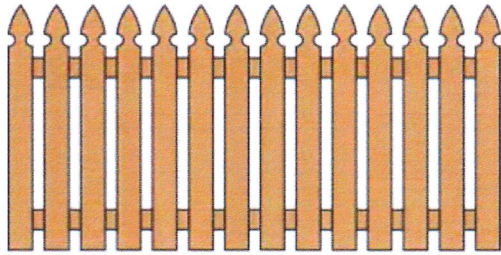

FRENCH-GOTHIC-WOOD-FENCE-STYLE

4' Pine Picket

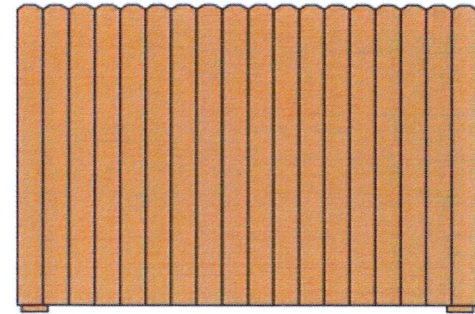

PRIVACY-WOOD-FENCE-STYLE

6' Pine Privacy



Vinyl Lattice

FENCE LAYOUT - NOT DRAWN TO SCALE



Covington Office: (985) 966-0604
Denham Office: (225) 443-3356

Customer Name Sam Leone
22176 12th Street
Abita Springs, LA 7042s

GATE CODE: N/A

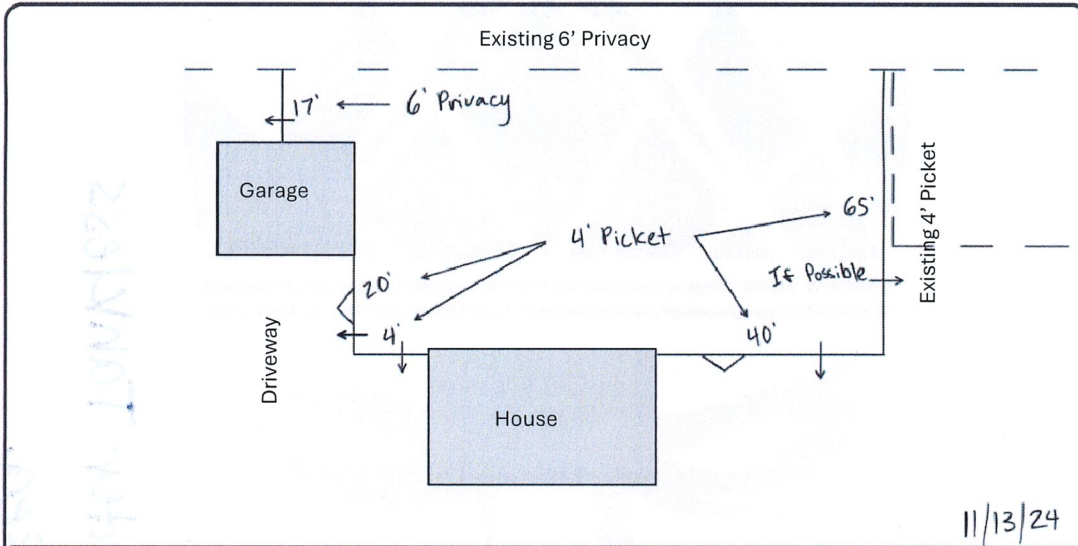

3102
FAL JUMPER

LEGEND

- Dotted lines indicate existing fence not to be touched.
- Solid lines indicate new fence location.
- ← ↑ → ↓ Arrows indicate the facing direction of finished side of fence.

Estimated By: <u>Zach</u>	WOOD MATERIALS <input checked="" type="checkbox"/> Wood Post <u>4x4s + 4x6's</u> <input checked="" type="checkbox"/> <u>Concreted</u>	FINISH SIDE TO FACE: Outward <input checked="" type="checkbox"/> Front (s) <input checked="" type="checkbox"/> Left Side <input checked="" type="checkbox"/> Right Side <input type="checkbox"/> Back	WOOD GATES: <input type="checkbox"/> Arched <input checked="" type="checkbox"/> <u>N/A</u>	ALUMINUM: <input type="checkbox"/> Flat Top <input type="checkbox"/> Spear Top <input type="checkbox"/> Front(s) <input type="checkbox"/> Side(s) <input type="checkbox"/> Back <input type="checkbox"/> Gate(s) <input type="checkbox"/> Single(s) <input type="checkbox"/> Double(s)	CHAIN LINK: <input type="checkbox"/> Galvanized <input type="checkbox"/> Black <input type="checkbox"/> 11.5 Gage Res <input type="checkbox"/> 9 Gage Comm <input type="checkbox"/> _____ Height <input type="checkbox"/> Barbwire <input type="checkbox"/> Gates <input type="checkbox"/> Single(s) <input type="checkbox"/> Double(s)
Verified By: <u>Zach</u>	<input type="checkbox"/> Postmaster <input type="checkbox"/> Cedar Front(s) <input type="checkbox"/> Cedar Side(s) <input type="checkbox"/> Cedar Back <input checked="" type="checkbox"/> Pine Front(s) <u>4' Picket</u> <input checked="" type="checkbox"/> Pine Side(s) <u>4' Picket, 6' Privacy</u> <input type="checkbox"/> Pine Back	Inward <input type="checkbox"/> Left Side <input type="checkbox"/> Right Side <input type="checkbox"/> Back	PORTHOLE: <input type="checkbox"/> Winery Grape <input type="checkbox"/> Fleur de Lis <input checked="" type="checkbox"/> <u>N/A</u>	<input type="checkbox"/> Color <input type="checkbox"/> Finile <input checked="" type="checkbox"/> <u>N/A</u>	<input checked="" type="checkbox"/> <u>N/A</u>
TEAR DOWN: <input type="checkbox"/> Yes <input type="checkbox"/> No <input checked="" type="checkbox"/> <u>None</u>	HAUL OFF: <input type="checkbox"/> Yes <input checked="" type="checkbox"/> No	POOL CODE: <input type="checkbox"/> Yes <input checked="" type="checkbox"/> No	CEDAR CAPPING: <input type="checkbox"/> Fronts <input type="checkbox"/> Everything <input checked="" type="checkbox"/> <u>N/A</u>	<input type="checkbox"/> Double(s) <input type="checkbox"/> Single(s)	<input checked="" type="checkbox"/> <u>N/A</u>
HAS A DOG: <input checked="" type="checkbox"/> Yes <input type="checkbox"/> No <input checked="" type="checkbox"/> <u>Small</u>	DOGGY DOME: <input type="checkbox"/> Yes <input type="checkbox"/> No <input checked="" type="checkbox"/> <u>None</u>	MUD BOARD: <input type="checkbox"/> 2x6 <input type="checkbox"/> 2x8 <input type="checkbox"/> 2x12 <input checked="" type="checkbox"/> <u>None</u>	TRANSITIONS: <input type="checkbox"/> Yes <input type="checkbox"/> No <input checked="" type="checkbox"/> <u>No</u>	<input type="checkbox"/> Double(s) <input checked="" type="checkbox"/> <u>N/A</u>	<input checked="" type="checkbox"/> <u>N/A</u>