

# Town of Abita Springs

Historic Meeting Date: 11/10/2020

## APPLICATION FOR HISTORIC COMMISSION APPROVAL / CERTIFICATE OF APPROPRIATENESS

Date: 11.05.2020

- Owner
- Applicant

### Type of Approval

- New Construction
- Renovation
- Other: \_\_\_\_\_
- Accessory Building (not livable)
- Ancillary Building (livable structure)

APPLICATION FOR PERMIT TO: (Briefly describe project- Use separate paper if necessary)

RESTORE EXISTING SHED

APPLICANT NAME: JUAN DE DIOS MIRAFLORES

Email: JUAN.MIRAFLORES@TRIPLEMPROFESSIONAL.COM Phone: 504.329.0386

Address: 22084 MAIN ST, ABITA SPRINGS, LA 70420

### OWNER (IF DIFFERENT FROM APPLICANT):

Email: \_\_\_\_\_

Phone: \_\_\_\_\_

Address: \_\_\_\_\_

### CONTRACTOR NAME & COMPANY: SELF

Email: \_\_\_\_\_

Phone: \_\_\_\_\_

Address: \_\_\_\_\_

  
Signature of Owner

11.05.2020  
Date

Signature of Applicant

Date

**Do Not Write Below this Line**

**7 DAYS NOTICE REQUIRED BEFORE FINAL APPROVAL OF CONSTRUCTION. IF YOU BUILD IN THE HISTORIC DISTRICT APPROVAL MUST BE GIVEN BEFORE YOUR CERTIFICATE OF OCCUPANCY WILL BE ISSUED.**

### Commissioners Initial

Ron Blicht \_\_\_\_\_

Review Date: \_\_\_\_\_

Otto Dinkelacker \_\_\_\_\_

Approved: \_\_\_\_\_

Thad Mancil \_\_\_\_\_

Andre Monnot \_\_\_\_\_

Commissioner Assigned: \_\_\_\_\_

Paul Vogt \_\_\_\_\_

Work Completed as Presented: \_\_\_\_\_

Inspected on Date: \_\_\_\_\_

APPLICATION FOR HISTORIC COMMISSION APPROVAL / CERTIFICATE OF APPROPRIATENESS

SUBJECT PROPERTY

Street Address or Legal Description: 22084 MAIN ST

Nearest Cross Streets: HWY 59 Lot Dimensions: 59 x 82 x 5 x 28 x 64 x 110

Work Begins: 11.16.2020 Estimated Completion Date: 11.30.2020

RESIDENTIAL HISTORIC CHECK LIST

FOUNDATION [x] Concrete Block [ ] Brick [ ] Continuous Chain Wall [ ] Raised Slab (36" above ground)

CRAWLSPACE [x] 24" Clear

SIDING [ ] Vinyl [x] Wood [ ] Hardie Plank

ROOF [x] Metal [ ] Fiberglass Shingles Slope: [ ] 8/12 Minimum

FRONT PORCH [x] Wood [ ] 7' Minimum Depth 2/3 Minimum Front Width of House: [ ] Yes [ ] No

CHIMNEY [ ] Stovepipe [ ] Brick [x] None

STEPS [x] Wood [ ] Bricks Railing: [ ] Wood [ ] Spacing 4"

HEIGHT Height of Building: 35' Maximum

WINDOW TRIM [ ] Vinyl [x] Wood [ ] Hardie Plank [ ] Other

TRIM [ ] Vinyl [x] Wood [ ] Hardie Plank [ ] Other

COLUMNS [ ] Vinyl [ ] Wood [ ] Hardie Plank [x] Other BRICK

DOORS [ ] Vinyl [x] Wood [ ] Hardie Plank [ ] Other

SHUTTERS [ ] Vinyl [ ] Wood [ ] Hardie Plank Must be 1/2 Width of Windows [ ] Yes [ ] No

ACCESSORY BUILDINGS [ ] Garage [x] Shed [ ] Other

FENCES [x] Wood Type: [ ] 4' Picket [ ] 7' Privacy [ ] 6' Privacy with 2' Lattice

LIGHTING No Fluorescent Strip Lighting or Fixtures

SIGNS [ ] Permanent [ ] Temporary









22078 Main St  
Abita Springs, Louisiana



Google

Street View

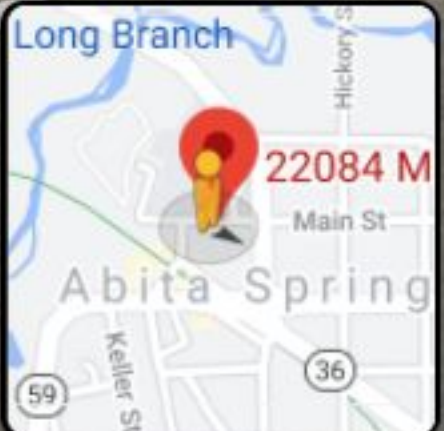

Google





22084 Main St  
Abita Springs, Louisiana



Street View

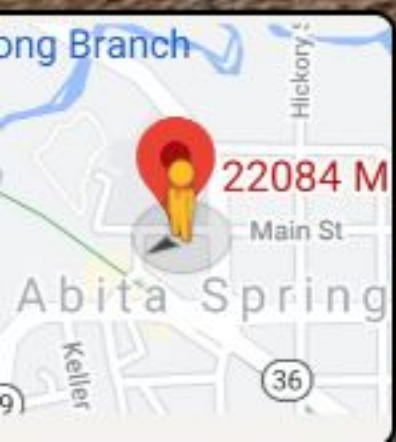

Google



22084 Main St

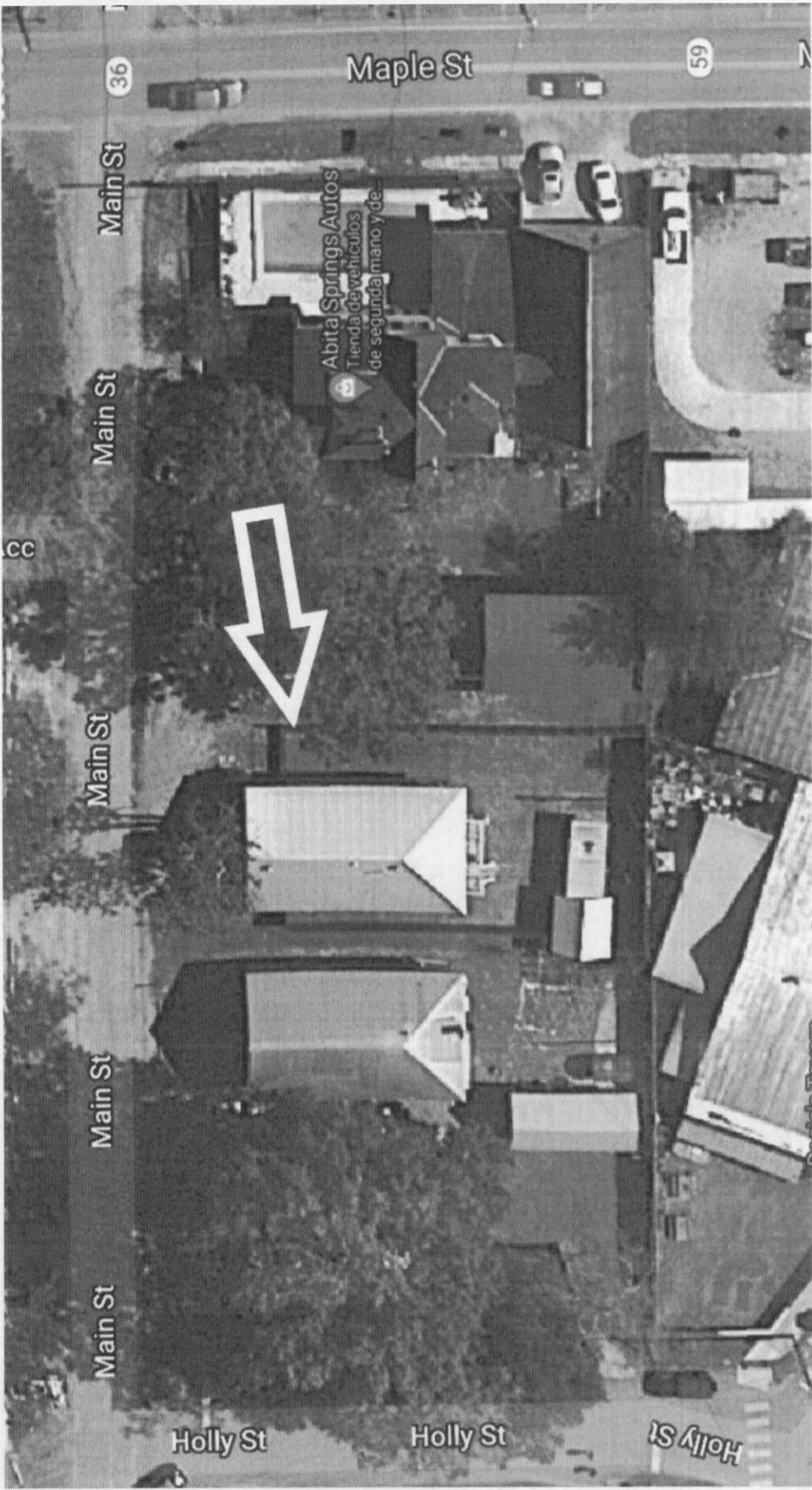

Maple St

Main St

Main St

Main St

Main St

Main St

Holly St

Holly St

Holly St

Abita Springs Autos  
Tienda de vehículos  
de segunda mano y de...

CC

59

36





**Parcels**  
 1150314366 Street View

**Assessment Number:** 1150314366  
**Property Address:** 22084 MAIN ST  
**Owner Name:** MIRA, ALVARO E  
**Mailing Address:** MIRA, JOSE D  
**Mailing Address 2:** 70367 10TH ST  
**Mailing City State Zip:** COVINGTON, LA 70433  
**Subdivision:** NORTHEAST DIV ABITA  
**Subdivision Square:**  
**Lot Number:** C  
**Property Description:** PARCEL C MEAS 59.0 X 82.0 X 5.0 X 28.0 X 64.0 X 110.0 IN SQ 17 NORTHEAST DIVISION ABITA SPRINGS CB 1372 830 INST NO 916631 INST NO 997863 INST NO 1162471 INST NO 1270687 INST NO 2017963

<b>Assessed Value:</b>	12971
<b>Homestead Amount:</b>	0
<b>Tax Value:</b>	12971
<b>Improvement Value:</b>	8831
<b>Parish Tax:</b>	1900.38
<b>City Tax:</b>	205.72

Close Export Print Labels

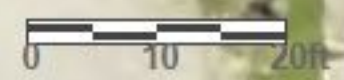



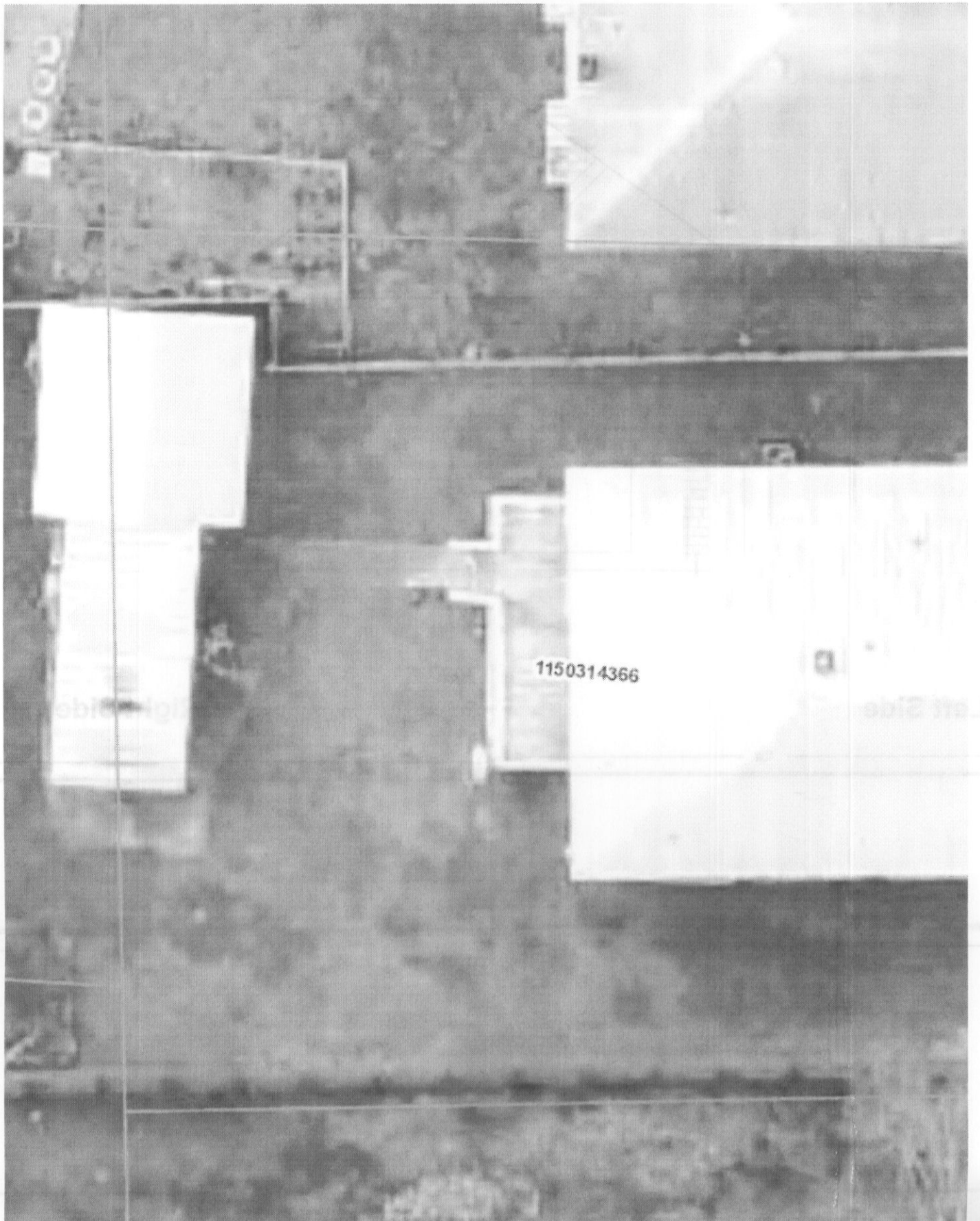

1150314366

1150314366

Left Side

Left Side



### Front View

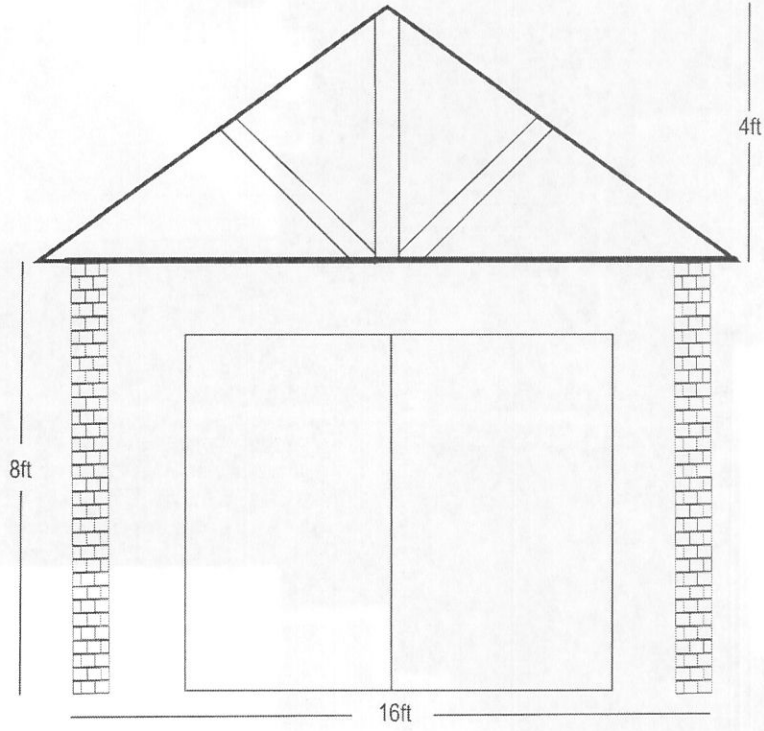

### Left Side

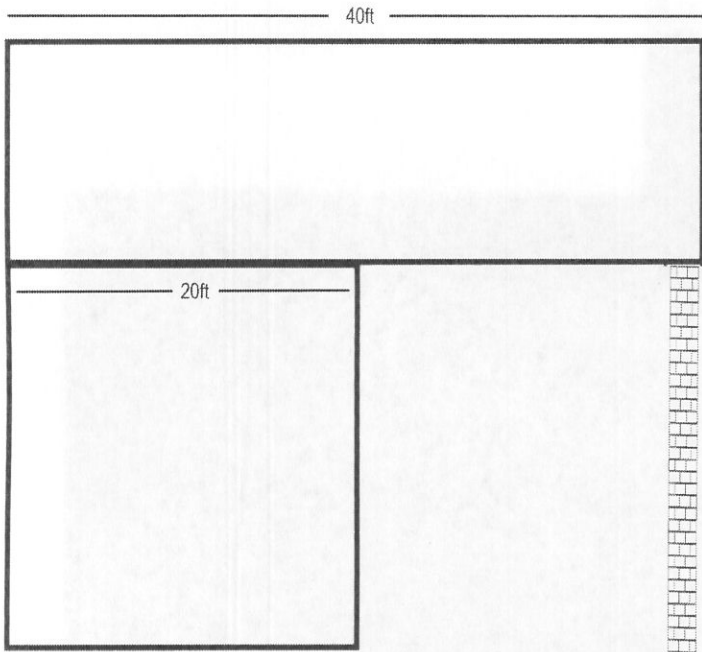

### Right Side

